



www.Source1Parts.com

ERCS SERIES, 13 SEER AIR CONDITIONER (STYLE G)

HVAC SERVICE PARTS

Supersedes: Nothing

035-20534-001 Rev. A (0704)

1 of 4

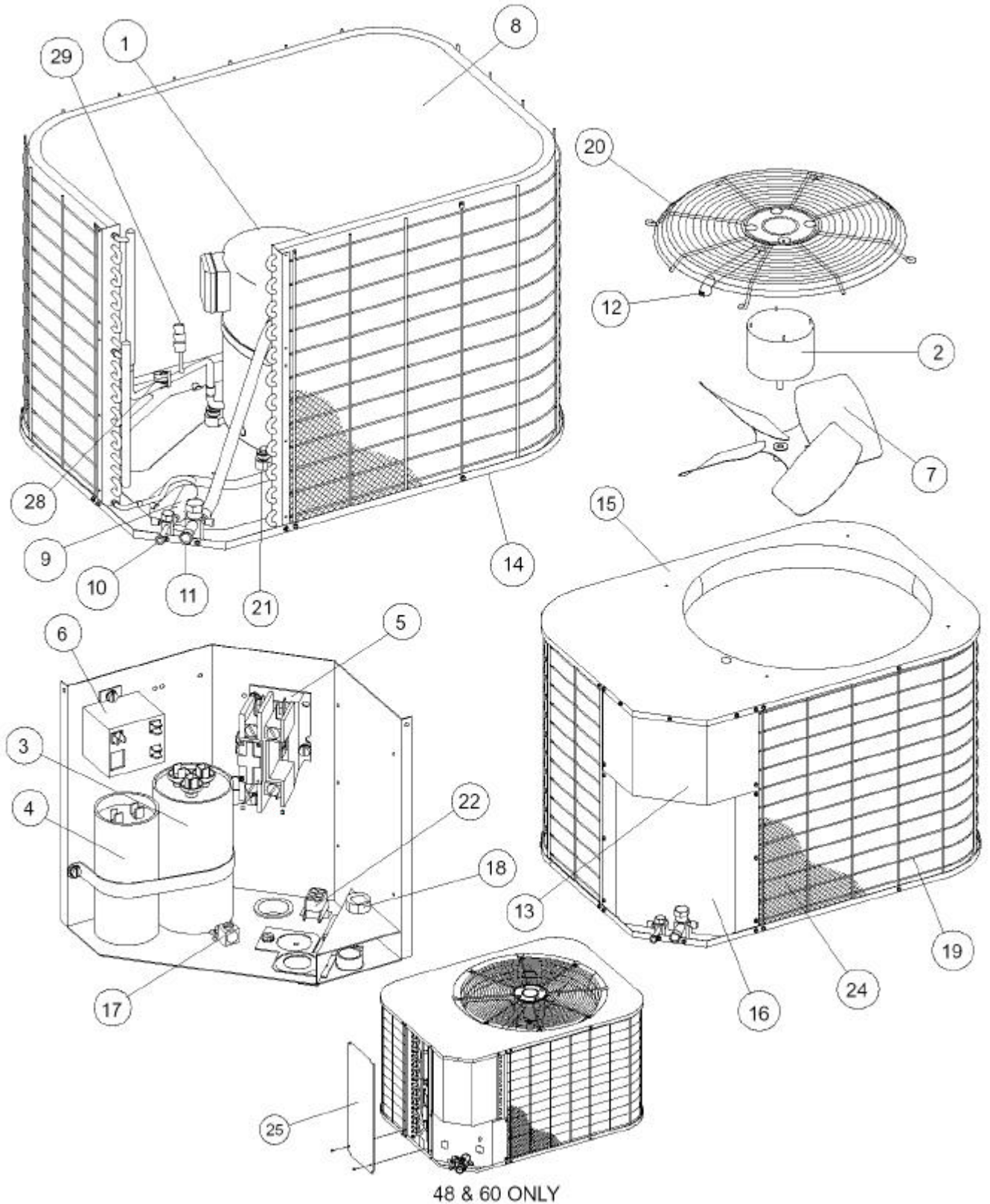

Models 18, 24, 30, and 36

ITEM	DESCRIPTION	ERCS0181BAG	ERCS0241BAG	ERCS0301BAG	ERCS0361BAG	<
1	Compressor, Hermetic	015-03426-004	015-03428-004	015-03431-001	015-03423-001	
1A*	Compressor Plug Harness	025-31884-000	025-31884-000	025-31884-000	025-31884-000	
2	Motor, Direct Drive Fan	024-26029-000	024-26029-000	024-26029-000	024-27596-000	
3	Capacitor, Run (30/5MFD) [RC]	024-24778-000	024-24778-000	---	---	
	Capacitor, Run (35/5MFD) [RC]	---	---	024-23998-000	024-23998-000	
4	Capacitor, Start	024-25062-000	024-25062-000	024-25071-000	1497-1451	
5	Contact, Electrical (30 AMP) [M]	024-27531-000	024-27531-000	024-27531-000	024-27531-000	
6	Relay, Start	024-25916-000	024-25916-000	024-25391-000	024-25391-000	
7	Blade, Fan (22")	026-34097-000	026-34097-000	026-34097-000	026-34094-000	
8	Coil, Condenser	373-19800-004	373-19800-004	373-19800-019	373-19800-020	
9	Drier, Filter	029-22156-000	029-22156-000	029-22157-000	029-22157-000	
10	Valve, Liquid (3/8")	025-31899-000	025-31899-000	025-31899-000	025-31899-000	
11	Valve, Suction (3/4")	025-31900-000	025-31900-000	---	---	
	Valve, Suction (7/8")	---	---	025-31901-000	025-31901-000	
12	Wireway	028-13216-001	028-13216-001	028-13216-001	028-13216-001	
13	Cover, Electrical Box	073-20018-001	073-20018-001	073-20018-001	073-20018-001	
14	Pan, Base	073-20004-801	073-20004-801	073-20004-801	073-20004-801	
15	Panel, Top	073-20042-801	073-20042-801	073-20042-801	073-20042-801	
16	Plate, Blockoff	073-20002-801	073-20002-801	073-20002-803	073-20002-802	
17	Lug, Ground	025-21798-000	025-21798-000	025-21798-000	025-21798-000	
18	Relief, Strain	025-09687-000	025-09687-000	025-09687-000	025-09687-000	
19	Guard, Coil	373-23707-001	373-23707-001	373-23709-001	373-23710-001	
20	Guard, Fan	026-35511-822	026-35511-822	026-35511-822	026-35511-822	
21	Mount, Cushion (Pkg. of 4)	9435-1081	9435-1081	9435-1081	9435-1081	
22	Plug, Electrical	025-33306-006	025-33306-006	025-33306-006	025-33306-006	
23*	Diagram, Wiring	035-15861-501	035-15861-501	035-15861-501	035-15861-501	
24	Coil Guard, Plastic Mesh	028-14728-000	028-14728-000	028-14731-000	028-14733-000	
25	Panel, Filler	---	---	---	---	
26*	Heater, Crankcase	---	---	1450-9511	---	
27*	Kit, Acorn Nut	363-90117-700	363-90117-700	363-90117-700	363-90117-700	
28	Switch, High Temperature	---	---	---	---	
29	Switch, High Pressure	---	---	---	---	

NOTE: *Not Shown

New replacement parts shown in **bold** face type at the first printing of parts list dated 7/04.

Major components and suggested stocking items are shown with shaded item number.

"<" Across from row indicates a change in that row.

--- Not applicable to specified model.



Models 42, 48, and 60

ITEM	DESCRIPTION	ERCS0421CAG	ERCS0481CAG	ERCS0481BAG	<
1	Compressor, Hermetic	015-02764-004	015-02773-004	015-02967-004	
1A*	Compressor Plug Harness	025-31884-000	025-31884-000	---	
2	Motor, Direct Drive Fan	024-27596-000	024-27596-000	024-32029-000	
3	Capacitor, Run (50/5MFD-370V) [RC]	024-25338-000	---	---	
	Capacitor, Run (60/5) [RC]	---	024-25033-000		
	Capacitor, Run (60/10) [RC]	---	---	024-32030-000	
4	Capacitor, Start	---	---	024-25062-000	
5	Contact, Electrical (30 Amp) [M]	024-27531-000	024-27531-000	024-27531-000	
6	Relay, Start	---	---	024-25035-000	
7	Blade, Fan (22")	026-34094-000	---	---	
	Blade, Fan (24")	---	026-35437-000	026-35491-000	
8	Coil, Condenser	373-19800-008	373-19014-404	373-19014-404	
9	Drier, Filter	026-34095-000	026-34095-000	026-34095-000	
10	Valve, Liquid (3/8")	025-31899-000	025-31899-000	025-31899-000	
11	Valve, Suction (7/8")	025-31901-000	025-31901-000	---	
	Valve, Suction (1 1/8")	---	---	023-18363-000	
12	Wireway	028-13216-001	028-13297-000	028-13297-000	
13	Cover, Electrical Box	073-20018-001	073-19009-501	073-19009-501	
14	Pan, Base	073-20004-801	073-19001-500	073-19001-500	
15	Panel, Top	073-20042-801	073-19002-501	073-19002-501	
16	Plate, Blockoff	073-20002-802	073-19008-536	073-19008-536	
17	Lug, Ground	025-21798-000	025-21798-000	025-21798-000	
18	Relief, Strain	025-09687-000	025-09687-000	025-09687-000	
19	Guard, Coil	373-23710-001	373-23715-007	373-23715-007	
20	Guard, Fan	026-35511-822	026-35511-824	026-35511-824	
21	Mount, Cushion (4 Req'd)	028-12355-000	028-12355-000	028-10190-000	
22	Plug, Electrical	025-33306-006	025-33306-006	025-33306-006	
23*	Diagram, Wiring	035-15861-501	035-15861-501	035-15861-501	
24	Coil Guard, Plastic Mesh	028-14733-000	028-14734-000	028-14734-000	
25	Panel, Filler	---	073-19007-536	073-19007-536	
26*	Heater, Crankcase	---	---	---	
27*	Kit, Acorn Nut	363-90117-700	363-90117-700	363-90117-700	
28	Switch, High Temperature	025-31926-000	---	025-31927-000	
29	Switch, High Pressure	---	---	025-33305-048	

NOTE: *Not ShownNew replacement parts shown in **bold** face type at the first printing of parts list dated 7/04.

Major components and suggested stocking items are shown with shaded item number.

"←" Across from row indicates a change in that row.

--- Not applicable to specified model.

Field Installed Accessories - Non-Electrical		
Part Number	Description	Used With
010-04621-000	Sound Blanket	018, 024, 030, 036
010-06234-000	Sound Blanket	042, 048
010-06243-000	Sound Blanket	060
2LA06700224	Low Ambient Kit	All Models
2PS06700324	Pressure Switch Kit	All Models

This document Appends:035-17714-001 Rev. D (0104).

TO ORDER AUTHORIZED FACTORY REPLACEMENT PARTS - Contact your Source1 HVAC Parts Distributor or visit our website at www.Source1Parts.com for a Distributor and Dealer listing.