

# SUBMITTAL DATA SHEET



**SINGLE PIECE AIR HANDLER  
SPLIT-SYSTEM FAN COIL  
MODELS: AVC\*(C) Series**

JOB NAME:		LOCATION:		
PURCHASER:		ORDER NO:		
ENGINEER:				
SUBMITTED TO:	FOR:	REF:	APPROVAL:	CONSTRUCTION:
SUBMITTED BY:		DATE:		
UNIT DESIGNATION:		SCHEDULE NO.	MODEL NO.	

## PRODUCT DATA

### Cooling Performance

Total Capacity\* \_\_\_\_\_ MBH  
Sensible Capacity\* \_\_\_\_\_ MBH  
Temperature of Air Entering  
Indoor Coil \_\_\_\_\_ °F (DB/WB)

### Supply Air Blower Performance

Total Supply Air \_\_\_\_\_ CFM  
Total External Static  
Pressure \_\_\_\_\_ IWG  
Blower Speed Settings \_\_\_\_\_  
Motor Rating \_\_\_\_\_ HP  
Power Input Requirement \_\_\_\_\_ KW

### Electrical Data

Power Supply \_\_\_\_\_ / \_\_\_\_\_ / \_\_\_\_\_  
Total Unit Ampacity \_\_\_\_\_ AMPS  
Minimum Wire Size \_\_\_\_\_ AWG  
(Copper conductors)  
Maximum Overcurrent Device  
 Fuses (Dual Element)  
 Circuit Breaker (HACR)

### Unit Weight

Total Unit Weight \_\_\_\_\_ LBS  
(Include field-installed accessories)

### Options

Factory Installed TXV

\* Shown in Outdoor Unit Technical Guide

## CLEARANCES

Front	24"
Rear	0"
Sides	0"

\* 0 Clearance allowed with or without Electric Heater.

## FEATURES

- Cooling or Heat Pump Applications.
- Durable pre-painted galvanized steel cabinet.
- Upflow/Downflow or 4-Way Position Models.
- Multi-position models easily converted, to Downflow and Horizontal Left.
- Composite drain pan for added strength and positive condensate removal.
- TXV refrigerant controls on all models (factory or field installed).
- **EcoTrak** comfort system allows dealer to customize comfort settings based on regional location.
- ECM motor, variable speed, Direct Drive with optional airflow cycles.
- Slide out blower and coil for service access.
- Easily installed electric heaters available (1&3ph) 4HK Series.
- Thermally insulated with 1" foil faced insulation (R-4.2).
- These models may be connected as part of a communications system using a 4-wire connection bus.

## FIELD INSTALLED ACCESSORIES

- Insulated Air Handler Cover (# \_\_\_\_\_)
- Electric Heaters (#4HK \_\_\_\_\_)  
Capacity (@ \_\_\_\_\_ Volts) \_\_\_\_\_ MBH  
Power Input Requirement (Less Blower Motor) \_\_\_\_\_ KW
- Thermal Expansion / Check Valve Kit (# \_\_\_\_\_)
- Combustible Floor Base (# \_\_\_\_\_)

## MATCHED OUTDOOR UNIT

- Model Number (# \_\_\_\_\_)
- Submittal Part Number (# \_\_\_\_\_)



## DIMENSIONS - INCHES

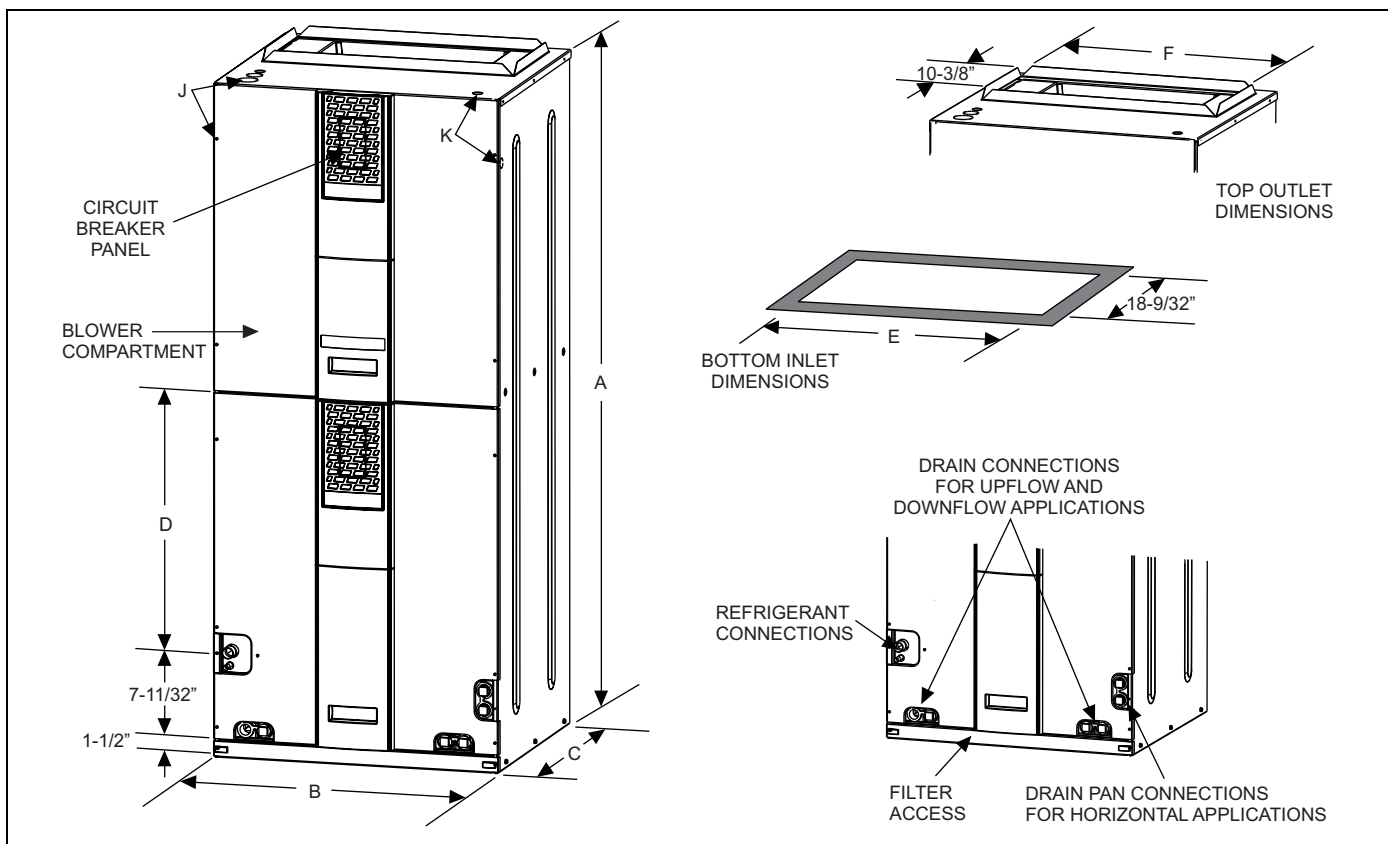

### DIMENSIONS

Models	Dimensions (Inches)						Wiring Knockouts <sup>1</sup>		Refrigerant Connections Line Size	
	A	B	C	D	E	F	J	K	Liquid	Vapor
	Height	Width	Depth				Power	Control		
AVC24B**H21C	46	17.5	21.5 (w/o cladding)	12-3/8	13-29/32	14-19/32	7/8" (1/2") 1 3/8" (1") 1 23/32" (1 1/4")	7/8" (1/2")	3/8"	3/4"
AVC36C**H21C	52	21		17-1/8	17-13/32	18-3/32				
AVC48D**H21C	57	24.5	22.5 (with cladding)	22-1/8	20-29/32	21-19/32				
AVC60D**H21C	57	24.5		22-1/8	20-29/32	21-19/32				7/8"

1. Actual size (Conduit size).

\*\* Thermal expansion device indicators - "3X" indicates unit is a "Flex Coil" models with a field installed R-22 or R-410A TXV, and "4\_" indicates R-410A TXV is factory installed. Letter indicates TXV size as required, see outdoor unit technical information for proper matches and requirements.